

GUIDELINES - PRESENTATIONS

GENERAL OVERVIEW

Speakers can upload their PowerPoint presentation **before coming to the congress** via the upload platform. Alternatively, speakers can upload their presentation onsite at the **Speaker Preview Room** at least 3 hours before the session starts. To upload your presentation, **please follow the link** received by email.

PRESENTATIONS DURING THE CONGRESS



Please present yourself to the **Speaker Preview Room** at least **3 hours before your session** to **check your presentation** and **take advantage of our practice stage**.



Arrive in session hall **30 minutes before your session**



A **chair** will **moderate** the session



You will start your presentation from the **lectern**



Your presentation will be followed by a **Q&A**.

FORMAT

Download our PPT template !

Details

16:9

- Format: **pptx** 16:9
- Size and font: common (min12)
- Maximum **300Mo**
- Bring a copy of your presentation and media on a **USB stick**

Media



- Use high quality images, graphs or tables
- Pictures must be **.jpeg** or **.png**, and videos must be **.mp4**
- Use the « **Insert** » function, not copy/paste
- **Anonymise** medical pictures/patients

3-7 May 2024

Glasgow, UK

ESTRO
2024

PRESENTATION UPLOAD



Open the **link** received by email (in **Google Chrome**)



Complete your **personal profile** and **declare your conflict of interests**



Read and sign the agreement



Upload your presentation (COI will be automatically added)



You will receive a **confirmation email**

INFORMATION ABOUT YOUR ACCOUNT

- If you **already have an account**, you can log in with your username and password (this is separate to your MyESTRO account)
- If not, you will need to **create an account**. The username must be the email address to which you received the instructions, and you can create a password of your choosing.

SPEAKER PREVIEW ROOM

Opening hours

Thursday 02nd May – 16:00 to 18:00
Friday 03rd May – 7:30 to 18:00
Saturday 04th May – 7:00 to 18:00
Sunday 05th May – 7:00 to 18:00
Monday 06th May – 7:00 to 18:00
Tuesday 07th May – 7:30 to 13:00

Location

Alsh 1

Timing

- Upload/check your presentation at least 3 hours before your session
- **You won't be able to use your laptop at the speaker lectern in the session hall**

For any question or technical support, please to contact us: support@cyimhelp.zendesk.com

INTERACTIVITY

STEP 1 : PREPARE YOUR PRESENTATION

Before the congress

- Insert **1 question slide** with the possible answers in your PPT

It's not mandatory but you can also add 1 answer slide highlighting the right answer(s) just after the question slide

- **Question format:**
 - > As a multiple-choice question form with a maximum of 5 possible answers
 - > By default, answers are presented as A, B, C, D and E but you can customize them
 - > Multiple answers questions are possible

STEP 2 : TAG YOUR VOTING SLIDES

At the Speaker Preview Room

- Select your **question slide**
- Select your **answer slide** (It's not mandatory to have one)

The technical team will help you in this process

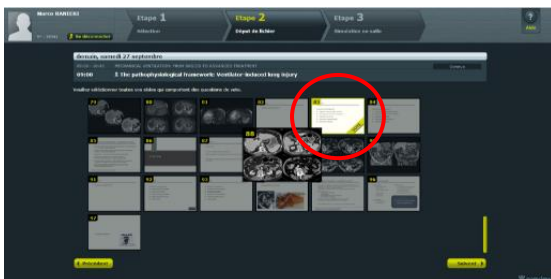

STEP 3 : MAKE THE AUDIENCE VOTE

In the lecture room

- Read the question and answers
- **Click on START VOTE**
- When you think the audience had enough time to vote, click on SHOW RESULTS to display the results
- Go to the next slide to stop the vote

